

(FOR FIRST DAY)
WEST GATE
PUBLIC
ENTRY

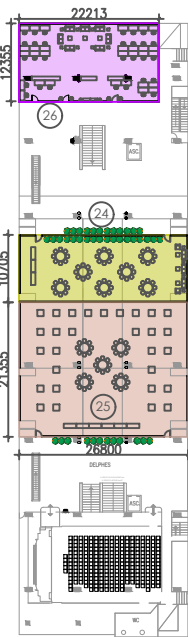

SECOND FLOOR
MEZZANINE

FIRST FLOOR MEZZANINE EAST WING

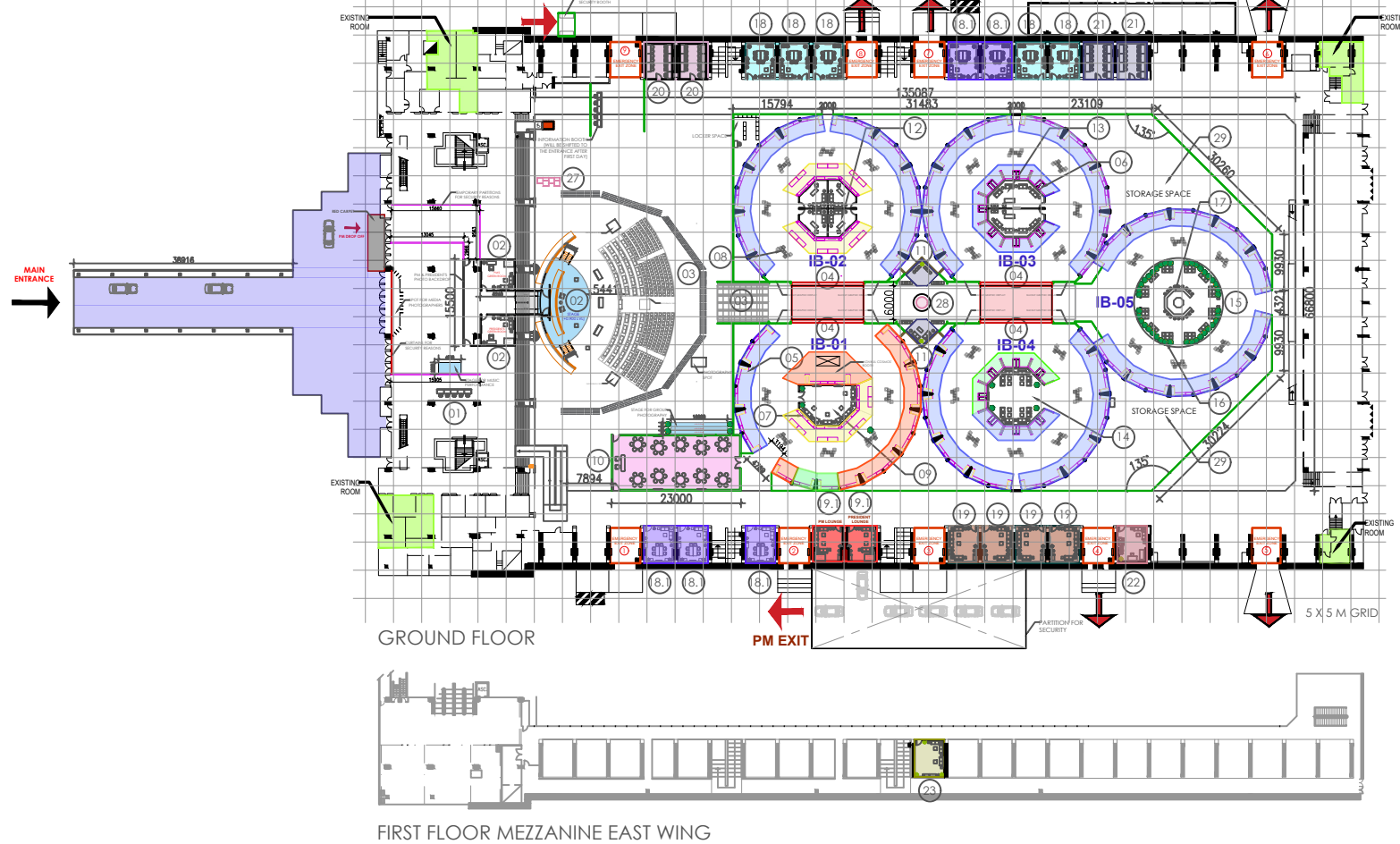
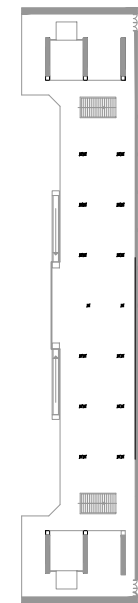

SECOND FLOOR
NORTH MEZZANINE

001 MASTER PLAN (17,000 SQM)
1:1200

LEGEND :

- IB-01 CENTRE (PM ROUTE) = 01 NOS (AGNIKUL COSMOS' BOOTH) ■
- IB-01 OUTER CIRCLE (PM ROUTE) = 10 NOS (TOP BEST INDIAN INNOVATORS) ■
- IB-01 OUTER CIRCLE (PM ROUTE) = 02 NOS (TOP BEST FRENCH INNOVATORS) ■
- IB-01 OUTER CIRCLE = 06 NOS (INDIAN INNOVATORS) ■
- IB-01 INNER CIRCLE = 04 NOS (TOP INDIAN INSTITUTES) ■
- IB-02 OUTER CIRCLE = 20 NOS (INDIAN INNOVATORS) ■
- IB-02 INNER CIRCLE = 06 NOS (INDIAN INSTITUTES) ■
- IB-03 OUTER CIRCLE = 20 NOS (INDIAN INNOVATORS) ■
- IB-03 INNER CIRCLE = 14 NOS (INDIAN INNOVATORS) ■
- IB-04 OUTER CIRCLE = 20 NOS (INDIAN INNOVATORS) ■
- IB-04 INNER CIRCLE = 14 NOS (FRENCH INNOVATORS) ■
- IB-05 OUTER CIRCLE = 20 NOS (INDIAN INNOVATORS) ■

- 01 INFORMATION KIOSK (9.4 X 5.25 = 49.4 SQM)
- 02 STAGE (LVL+0.9 M)
(16.5 X 9.85 = 162.5 SQM)
- GREEN ROOM (LVL+1.35 M) (QUANTITY - 02)
(5.3 X 5.8 = 30.7 SQM)
- AUDIENCE SPACE (LVL + 0.0 M)
(30 X 10 = 300 SQM)
- 03 FABRIC COVERING WALL
(RUNNING LENGTH = 74.5 M)
- 03 ENTRANCE (FABRIC)
(14.3 X 34 = 486.2 SQM)
- 03 INNOVATOR'S PHOTO WALL TUNNEL
(14.3 X 34 = 486.2 SQM)
- 04 ENTRANCE TO INNOVATOR'S BOOTH CIRCLE
(QUANTITY - 4)
(12 X 0.5 = 6 SQM)
- 05 BOOTH TYPE 01 - INNOVATOR'S BOOTH
OUTER CIRCLE (QUANTITY - 94)
(4 X 1.8 = 7.8 SQM)
- 06 BOOTH TYPE 02 - INNOVATOR'S BOOTH
INNER CIRCLE (QUANTITY - 28)
(3 X 2.75 = 8.25 SQM)
- 07 BOOTH TYPE 03 - INSTITUTE'S BOOTH (QUANTITY - 10)
(4.2 X 2.56 = 10.75 SQM)
- 08 SEATING WITH PLANTS (QUANTITY - 40 MODULES)
(2.65 X 1.35 = 3.75 SQM)
- 09 INVESTOR'S LOUNGE
(10 X 7 = 70 SQM)
- 10 CONFERENCE ROOM (PAX = 60 PEOPLE)
(23 X 10 = 230 SQM)
- 11 MEDIA SPACE
(4.3 X 4.3 = 18.5 SQM)
- 12 PITCHING ROOM TYPE 01 (QUANTITY - 04)
(12.3 X 4.5 = 55.3 SQM)
- 13 PITCHING ROOM TYPE 02 (QUANTITY - 02)
(7.4 X 5.3 = 39.2 SQM)
- 14 INNOVATOR'S LOUNGE
(10.4 X 10.4 = 108.2 SQM)
- 15 CAFETERIA
(14.6 X 14.6 = 213.2 SQM)
- 16 CAFETERIA PLANT BOX MODULES
(QUANTITY - 04)
(3.01 X 1.7 = 5.1 SQM)
- 17 CAFETERIA BAR COUNTER
(9.95 X 9.95 = 98.8 SQM)
- 18 BILATERAL ROOMS
(QUANTITY - 05)
(5.20 X 6.20 = 32.2 SQM)
- 18.1 VVIP BILATERAL ROOM
(QUANTITY - 05)
(5.20 X 6.20 = 32.2 SQM)
- 19 VVIP LOUNGE ROOM
(QUANTITY - 04)
(5.20 X 6.20 = 32.2 SQM)
- 19.1 VVIP LOUNGE ROOM (FOR PM & PRESIDENT)
(QUANTITY - 02)
(5.20 X 6.20 = 32.2 SQM)
- 20 COMMAND ROOM
(QUANTITY - 02)
(5.20 X 6.20 = 32.2 SQM)
- 21 PRESS ROOM
(QUANTITY - 02)
(5.20 X 6.20 = 32.2 SQM)
- 22 EMERGENCY MEDICAL ROOM
(QUANTITY - 01)
(5.20 X 6.20 = 32.2 SQM)
- 23 ALL FAITH PRAYER ROOM
(QUANTITY - 01)
(5.35 X 6.70 = 35.8 SQM)
- 24 VVIP LUNCH SPACE
(11.9 X 16.5 = 196.3 SQM)
- 25 DELEGATE'S LUNCH SPACE
(32 X 12 = 385 SQM)
- 26 MOE OFFICE SPACE
(26.8 X 9.3 = 250 SQM)
- 27 SELFIE POINT 01
(4 X 1 = 4 SQM)
- 28 SELFIE POINT 02
(2.10 X 2.10 = 4.4 SQM)
- 29 STORAGE AREA (QUANTITY = 02)
(395 SQM)

FOR TENDER